

18013 – Ueno, Tokamachi City

For Sale

Kawanishi

Close to onsen; close to preschools

Comments

This dwelling is in the Kawanishi area of Tokamachi City, which is roughly a 15 minute drive to Tokamachi City center.

This residence was meticulously taken care of so living here will be comfortable.

Surrounded by nature, this house is just a 5 minute drive to the nearest onsen and offers a great space to relax at the end of the day.

Reference Number	18013
Date Available	March 14 th , 2022
Type	For Sale
Price	10,000,000yen
Layout	7DK
Year Built	1950
Area	Kawanishi
Location	Ueno, Tokamachi City, Niigata Prefecture (see map)
House Size	224.00 m ²
Land Size	793.39 m ²
Parking	Uncovered Parking: 2+ spaces
Features	Electricity: Installed (contract needed) Gas Hookups: Installed (LPG contract needed) Plumbing: Part of the city water system; personal well (spring water) Bath: Kerosene Toilet: 1 Western-style toilet Sewer system: Connected
Roof-top Snow Removal	Necessary
Nearby Facilities	Ueno Preschool (approx. 2.2km) Ueno Elementary School (approx. 1.9km) Kawanishi Junior High School (approx. 2.4km) Tokamachi City Hall, Kawanishi Branch (approx. 4.3km)

	<p>Kawanishi Clinic (approx. 2.4km)</p> <p>Tokamachi Fire Station (approx. 6.3km)</p> <p>Kawanishi Police Station (approx. 3.4km)</p> <p>Tokamachi Station (Iiyama and Hokuho Lines) (approx. 7.8km)</p> <p>Ueno Bus Stop (approx. 0.1km)</p> <p>JA Bank Kawanishi Branch (approx. 3.2km)</p> <p>Ueno Post Office (approx. 2.0km)</p> <p>Senju Onsen (approx. 3.3km)</p>
Additional Comments	<p>Fields are available for purchase in the neighborhood; please consult if you wish to buy.</p> <p>A shared community farm tractor is available (tenant responsible for use).</p>
Inquiries	<p>Tokamachi City Policy Planning Division</p> <p>Phone: 025-755-5137 (Weekdays 8:30am – 5:15pm)</p> <p>Email: t-kikaku@city.tokamachi.lg.jp</p>



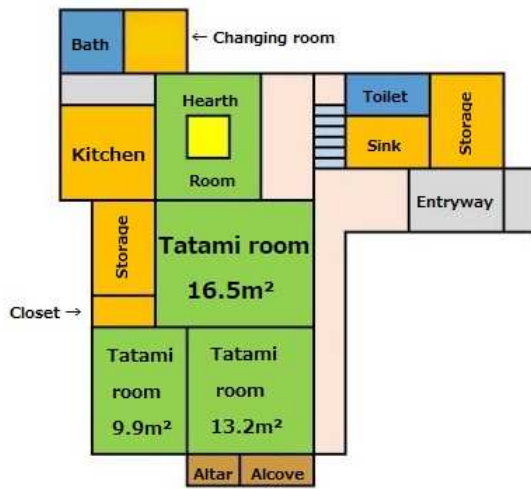

First Floor

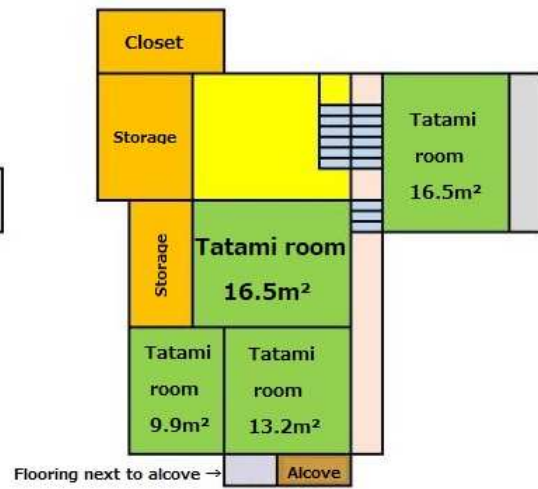

Second Floor

* Measurements are approximate.







