

20009 – Noguchi, Tokamachi City

For Sale

Kawanishi

Close to schools; snow-resistant roofing

Comments

This residence is located above a shop along route 49 and is a 20 minute drive from Tokamachi City center.

The shop below is currently empty, so the residence would be ideal for somebody looking to start their own business. Additionally, the second floor rooms are plentiful and all of them large, so you'll never run out of space!

The elementary school is especially close and perfect for a student walking to school on their own for the first time.

Reference Number	21009
Date Available	March 14 th , 2022
Type	For Sale
Price	5,500,000yen
Layout	8DK
Year Built	1987
Area	Kawanishi
Location	Noguchi, Tokamachi City, Niigata Prefecture (see map)
House Size	355.24 m ²
Land Size	460.46 m ²
Parking	Uncovered Parking: 1-2 spaces
Features	Electricity: Installed (contract needed) Gas Hookups: Not connected Plumbing: Part of the city water system Bath: Kerosene Toilet: 1 Western-style toilet, 1 Japanese-style squat toilet Sewer system: Connected
Roof-top Snow Removal	Snow-resistant roofing (4m)
Nearby Facilities	Ueno Preschool (approx. 3.2km) Tachibana Elementary School (approx. 0.3km) Kawanishi Junior High School (approx. 4.2km)

	<p>Tokamachi City Hall, Kawanishi Branch (approx. 5.6km)</p> <p>Kamimura Clinic (approx. 4.6km)</p> <p>Tokamachi Fire Station (approx. 8.5km)</p> <p>Nita Police Station (approx. 0.4km)</p> <p>Gejo Station (Iiyama Line) (approx. 4.8km)</p> <p>Kiotoshi Bus Stop (approx. 2.5km)</p> <p>JA Bank Kawanishi Branch (approx. 5.1km)</p> <p>Tachibana Post Office (approx. 0.1km)</p> <p>Senju Onsen (approx. 5.4km)</p>
Inquiries	<p>Tokamachi City Policy Planning Division</p> <p>Phone: 025-755-5137 (Weekdays 8:30am – 5:15pm)</p> <p>Email: t-kikaku@city.tokamachi.lg.jp</p>





First Floor

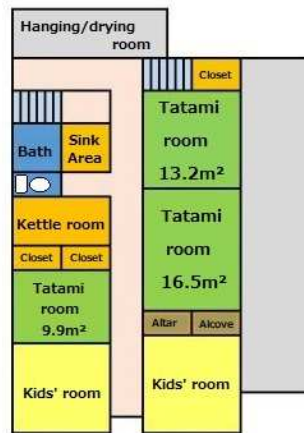

Second Floor

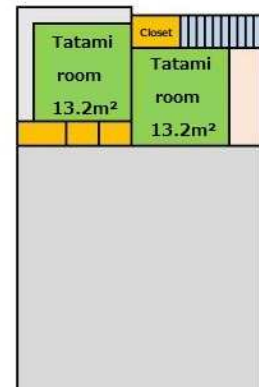

Third Floor

* Measurements are approximate.









