

## 21009 – Yokkamachi shinden, Tokamachi City

**For Sale**

Tokamachi

**Garage; close to onsen; close to schools; raised structure**

### Comments

Just a 10 minute drive from the Tokamachi City center.

Close to many facilities for a convenient lifestyle.

Living area is on the second floor in a typical Snow Country house design. Snow removal will depend on available sunlight.

Reference Number	21009
Date Available	March 14 <sup>th</sup> , 2022
Type	For Sale
Price	3,800,000yen
Layout	5DK
Year Built	1976
Area	Tokamachi
Location	Yokkamachi shinden, Tokamachi City, Niigata Prefecture (see <a href="#">map</a> )
House Size	177.56 m <sup>2</sup>
Land Size	205.66 m <sup>2</sup>
Parking	Uncovered Parking: 2+ spaces
Features	Electricity: Installed (contract needed) Gas Hookups: Installed (LPG contract needed) Plumbing: Part of the city water system Bath: Electric Toilet: 1 Western-style toilet Sewer system: Connected
Roof-top Snow Removal	Necessary
Nearby Facilities	Kirakira West Preschool (approx. 0.9km) Higashi Elementary School (approx. 0.7km) Nakajo Junior High School (approx. 2.1km) Tokamachi City Hall (approx. 2.4km) Ootsubo Clinic (approx. 0.3km)

	<p>Tokamachi Fire Station (approx. 1.0km) Nakajo Police Station (approx. 2.4km) Tokamachi Station (Iiyama and Hokuhoku Lines) (approx. 1.8km) Yokkamachi shinden Bus Stop (approx. 0.2km) JA Bank Tokamachi Branch (approx. 1.6km) Tokamachi Post Office (approx. 1.1km) Akashi no Yu Public Bath (in Kinare) (approx. 1.1km)</p>
Inquiries	<p>Tokamachi City Policy Planning Division Phone: 025-755-5137 (Weekdays 8:30am – 5:15pm) Email: <a href="mailto:t-kikaku@city.tokamachi.lg.jp">t-kikaku@city.tokamachi.lg.jp</a></p>



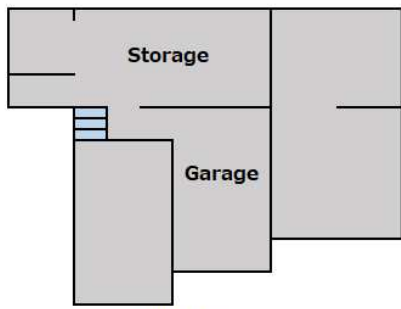

First Floor

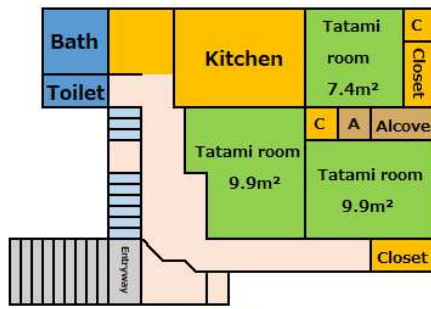

Second Floor

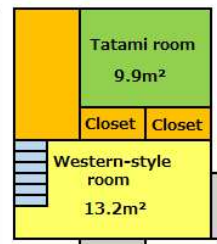

Third Floor

C = Closet

A = Altar space

\* Measurements are approximate.









