

## 21021 – Shinza, Tokamachi City

**For Sale**

Tokamachi

**Close to schools; close to onsen**

### Comments

Conveniently located near the center of town near schools and other everyday facilities, this house is less than a 5 minute drive to downtown.

Both Tokamachi and Shinza Stations are nearby, as is Route 117, so you can easily travel in and out of town, or even out of the prefecture.

The house is compact but has a balcony and other places to hang laundry, along with more storage space near the entryway.

Reference Number	21021
Date Available	April 25 <sup>th</sup> , 2022
Type	For Sale
Price	4,500,000yen
Layout	6DK
Year Built	1967
Area	Tokamachi
Location	Shinza, Tokamachi City, Niigata Prefecture (see <a href="#">map</a> )
House Size	128.87 m <sup>2</sup>
Land Size	163.02 m <sup>2</sup>
Parking	Uncovered Parking: 2 space (not accessible in winter)
Features	Electricity: Installed (contract needed) Gas Hookups: Not installed Plumbing: Part of the city water system Bath: Gas Toilet: 1 Western-style toilet Sewer system: Connected
Roof-top Snow Removal	Necessary
Nearby Facilities	Shinza Preschool (approx. 0.4km) Higashi Elementary School (approx. 1.2km) Tokamachi Junior High School (approx. 0.5km) Tokamachi City Hall (approx. 2.4km)

	<p>Otsubo Clinic (approx. 1.2km)</p> <p>Tokamachi Fire Station (approx. 2.2km)</p> <p>Tokamachi Police Station (next to the train station) (approx. 1.7km)</p> <p>Shinza Station (approx. 0.1km)</p> <p>Honcho 7-chome Bus Stop (approx. 0.5km)</p> <p>JA Bank Tokamachi Branch (approx. 1.6km)</p> <p>Tokamachi Post Office (approx. 1.0km)</p> <p>Akashi no Yu Public Bath (in Kinare) (approx. 1.0km)</p>
Inquiries	<p>Tokamachi City Policy Planning Division</p> <p>Phone: 025-755-5137 (Weekdays 8:30am – 5:15pm)</p> <p>Email: <a href="mailto:t-kikaku@city.tokamachi.lg.jp">t-kikaku@city.tokamachi.lg.jp</a></p>



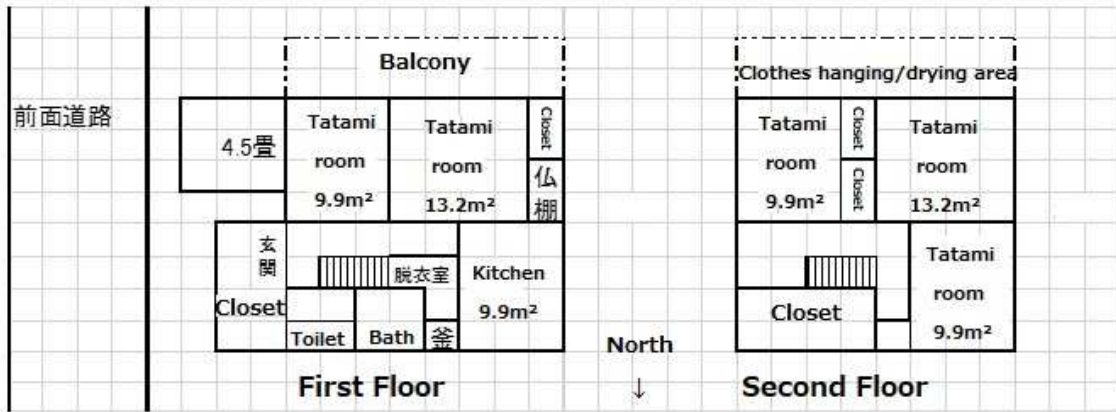

\* Measurements are approximate.









